

Recommended
P.C. Board Hole Layout

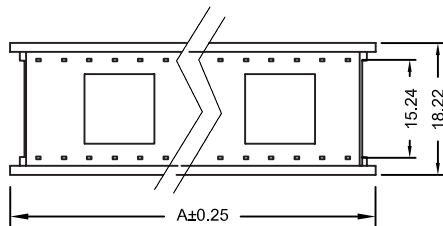
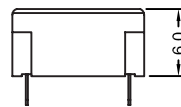
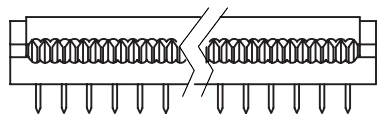
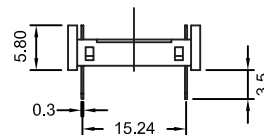
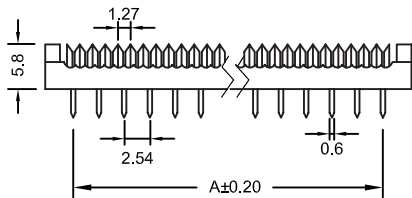
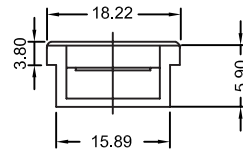
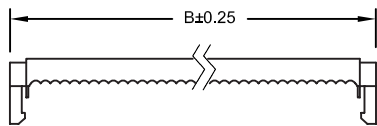
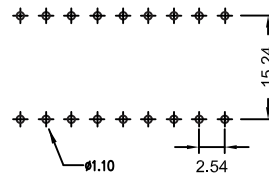

Specifications

- Current Rating: 3 Amps
- Insulator Resistance: 1000 Megohms min. @ 500VDC
- Contact Resistance: 15 Millions ohms max.
- Operating Temperature: -40°C ~ +105°C
- Insulator Material: PBT +30% Glass Fiber (UL94V-0)
- Contact Plated: See options

Part Numbering System

MC3 - XX - S - X

Series

No. of Contact:

Contact Plating:

S = Selective Gold (Standard)
Gold over nickel underplate on contact area,
Tin over copper underplate on IDC area

T = Tin

G = Full Gold Flash

Insulator Color:

Nil = Black

GRY = Grey

Contact	A	B
24	27.94	35.74
28	33.02	40.82
32	38.10	45.90
34	40.64	48.44
36	43.18	50.98
40	48.26	56.06

General Tolerance	
X. ± 0.50	X.° ± 5°
.X ± 0.20	.X° ± 2°
.XX ± 0.10	.XX° ± 1°
Units : mm	